

20 000 783

- hole diameter 32 mm
- rosette 60 x 60 mm
- with hot marking



|   |                                     |               |
|---|-------------------------------------|---------------|
|  | Platinum                            | 20 000 783-08 |
|  | Chrome                              | 20 000 783-00 |
|  | Brushed Platinum                    | 20 000 783-06 |
|  | Dark Chrome                         | 20 000 783-19 |
|  | Brushed Durabronze<br>(23kt Gold)   | 20 000 783-28 |
|  | Brushed<br>Champagne (22kt<br>Gold) | 20 000 783-46 |
|  | Champagne (22kt<br>Gold)            | 20 000 783-47 |
|  | Brushed Dark<br>Platinum            | 20 000 783-99 |

20 000 783

mm [inches]

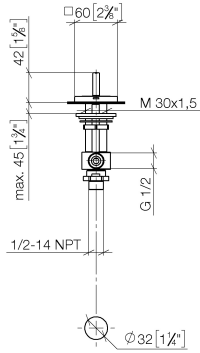

Flow rate chart



Codes & Standards

ADA ASME  
A112.18.1/CSA  
B125.1



## MEM Deck valve anti-clockwise closing hot - Platinum

---

MEM

20 000 783

### Certificates

---

IAPMO\_4976 (5).    WRAS\_2103001.

20 000 783

Parts for other finishes can be found here: [Chrome](#)

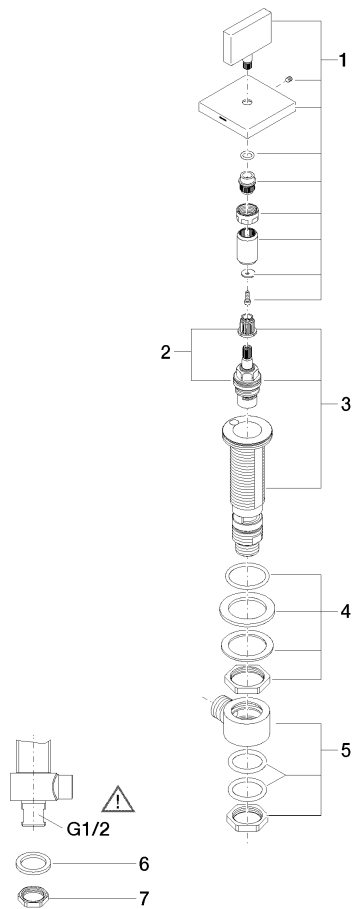

**Spare parts list**

| No. | Item Number        | Name           | Quantity used | Delivery time |
|-----|--------------------|----------------|---------------|---------------|
| 1   | 90 20 78 002 05-08 | handle ( hot ) | 1             | 40            |
| 2   | 90 90 03 132 00 90 | top            | 1             | 2             |
| 3   | 04 17 11 058 32 90 | side panel     | 1             | 2             |
| 4   | 04 23 10 032 78 90 | fixing set     | 1             | 2             |
| 5   | 04 17 11 023 10 90 | distributor    | 1             | 2             |
| 6   | 09 30 11 059 90    | disc           | 1             | 2             |
| 7   | 09 23 10 012 90    | nut            | 1             | 2             |